

WESTSAIL 42

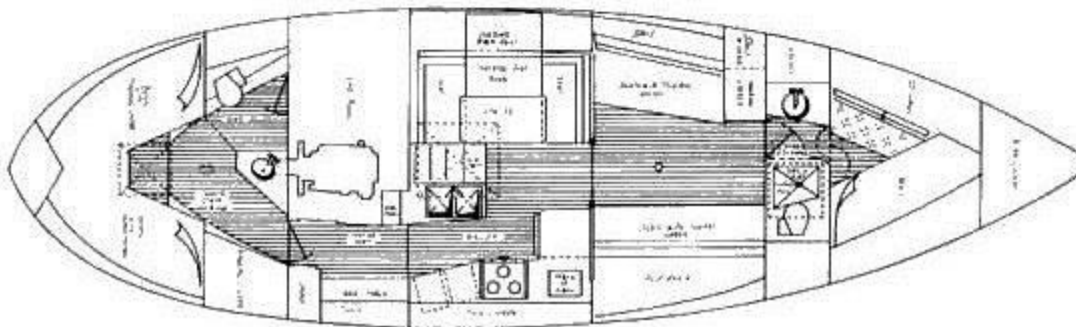
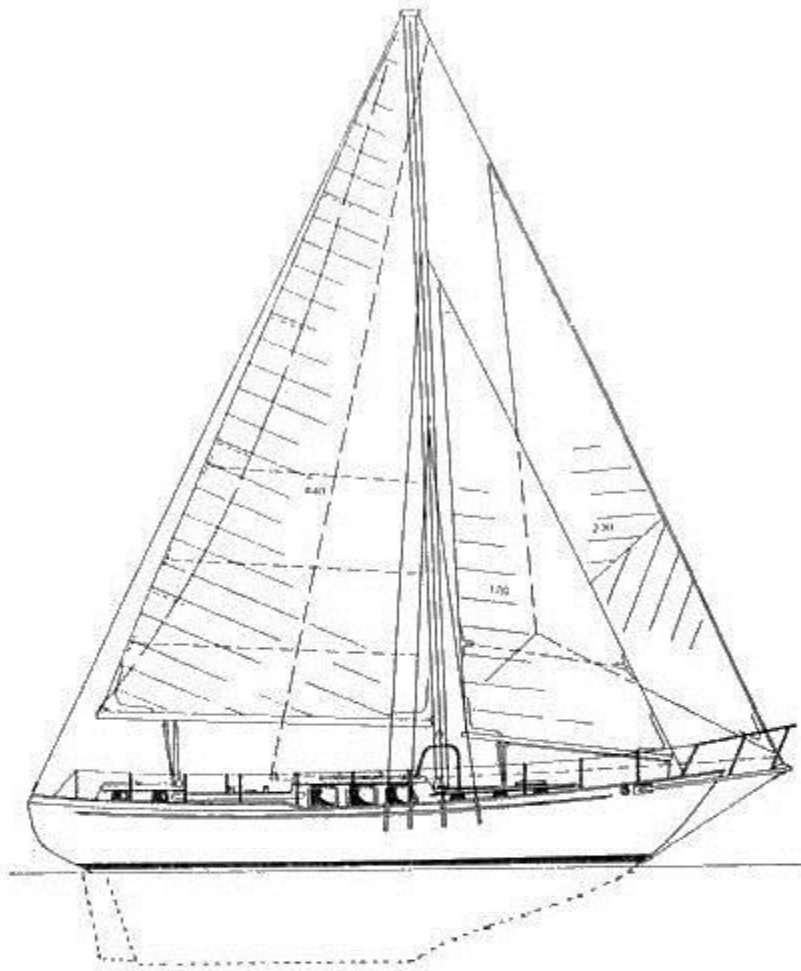

■

Hull Type:	Long Keel	Rig Type:	Cutter
LOA:	42.92' / 13.08m	LWL:	33.33' / 10.16m
Beam:	13.00' / 3.96m	Listed SA:	948 ft ² / 88.07 m ²

Draft (max.)	5.67' / 1.73m		Draft (min.)			
Displacement:	31500 lbs./ 14288 kgs.		Ballast:	12000 lbs. / 5443 kgs.		
Sail Area/Disp.1:	15.27	Bal./Disp.:	38.09%	Disp./Len.:	379.80	
Designer:	William Crealock					
Builder:	Westsail Corp. (USA)					
Construction:	FG			Bal. type:		
First Built:	1974	Last Built:		# Built:	65	
AUXILIARY POWER (orig. equip.)						
Make:	Perkins		Model:	4-236		
Type:	Diesel		HP:	85		
TANKS						
Water:	200 gals. / 1136 ltrs.		Fuel:	190 gals. / 757 ltrs.		
RIG AND SAIL PARTICULARS KEY						
I(IG):	49.50' / 15.09m		J:	20.50' / 6.25m		
P:	43.00' / 13.11m		E:	20.50' / 6.25m		
PY:			EY:			
ISP:			SPL/TPS:			
SA(Fore.):	507.38 ft ² / 47.14 m ²		SA(Main):	440.75 ft ² / 40.95 m ²		
Sail Area (100% fore+main triangles):				948.13 ft ² / 88.08 m ²		
Sail Area/Disp.2:	15.27	Est. Forestay Length.:	53.58' / 16.33m			
BUILDERS (past & present)						
More about & boats built by:			Westsail Corporation (USA)			
DESIGNER						
More about & boats designed by:			William Crealock			
RELATED LINKS						
Westsail Owners Association			www.westsail.org			
SEE ALSO:						
Related Boat:			WESTSAIL 43			